

FOOTBALL STADIUMS - BRAZIL

BRAZIL NATIONAL

CAPACITY : 78,838

CONSTRUCTED : 1950



Brazil National is used for regular International matches for the National football team.

The Maracana Stadium hosted the 1950 World Cup and the 2014 World Cup with 7 matches including the Final.



[PLAY STADIUM FLYBY](#)

FOOTBALL STADIUMS - BRAZIL

BELO HORIZONTE

CAPACITY : 61,846

CONSTRUCTED : 1965

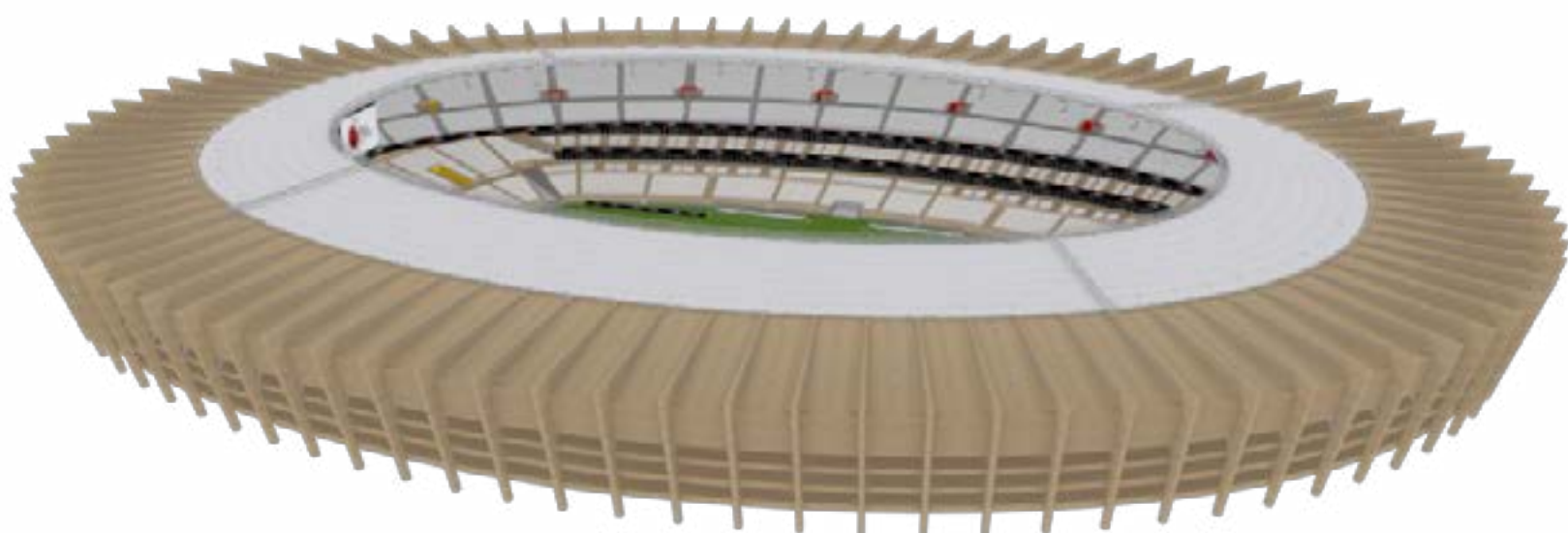

Belo Horizonte is used for regular team football in the Brazilian league, in Belo Horizonte.
The Mineirao Stadium hosted 6 games during the 2014 World Cup and games during the 2016 Summer Olympics.



[PLAY STADIUM FLYBY](#)

FOOTBALL STADIUMS - BRAZIL

BRASILIA

CAPACITY : 71,000

CONSTRUCTED : 2013

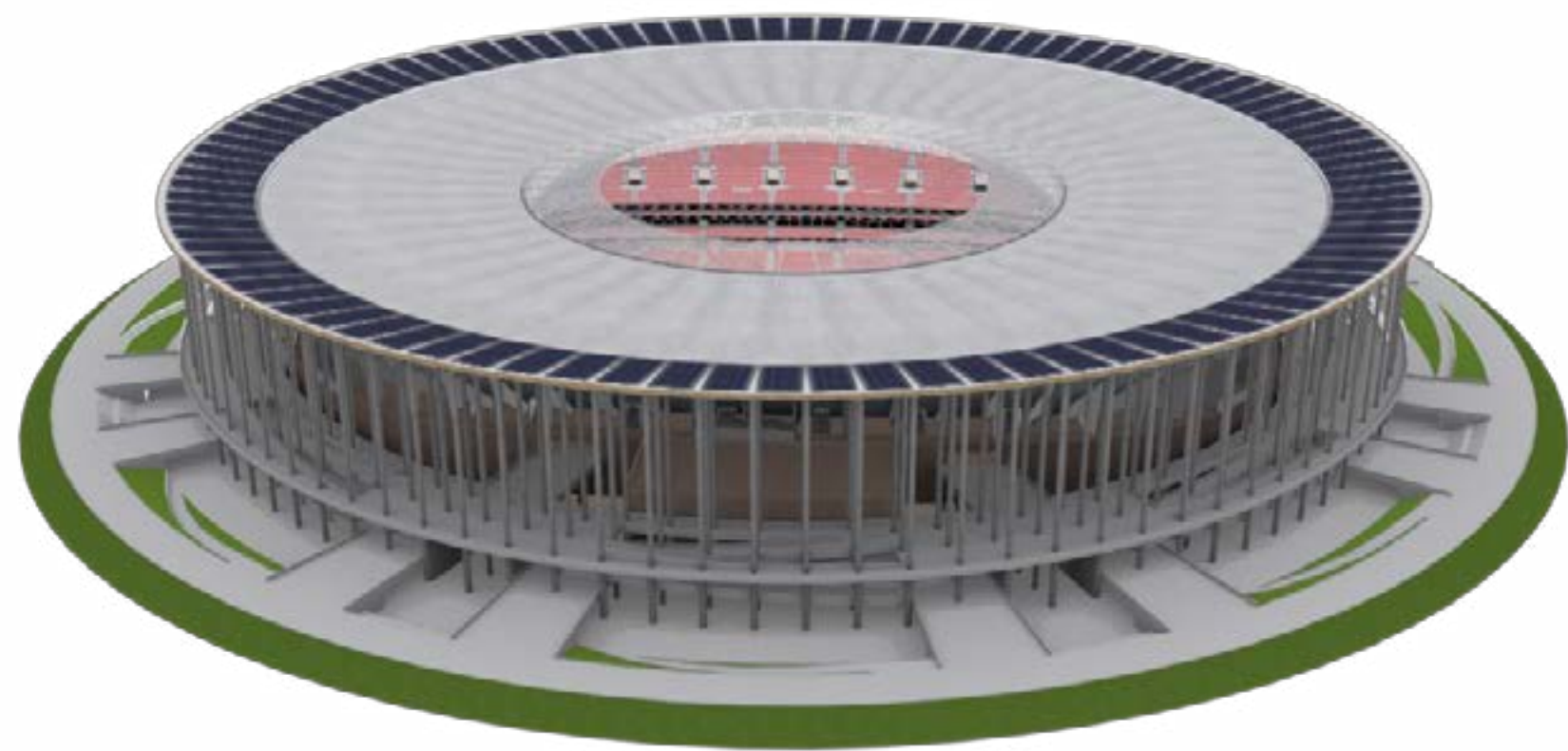

Brasilia is used for regular team football in the Brazilian league. The Mane Garrincha Stadium hosted 7 games during the 2014 World Cup and matches during the 2016 Summer Olympics and the 2013 Confederation Cup.



[PLAY STADIUM FLYBY](#)

FOOTBALL STADIUMS - BRAZIL

FORTALEZA

CAPACITY : 71,000

CONSTRUCTED : 2013



Fortaleza is used for regular team football in the Brazilian league; it's record attendance is 118,496, from 1980 when Brazil played. The Castelao Arena hosted 2014 World Cup will 6 matches, including a quarter final.



[PLAY STADIUM FLYBY](#)

FOOTBALL STADIUMS - BRAZIL

LUSO

CAPACITY : 30,000

CONSTRUCTED : 2005

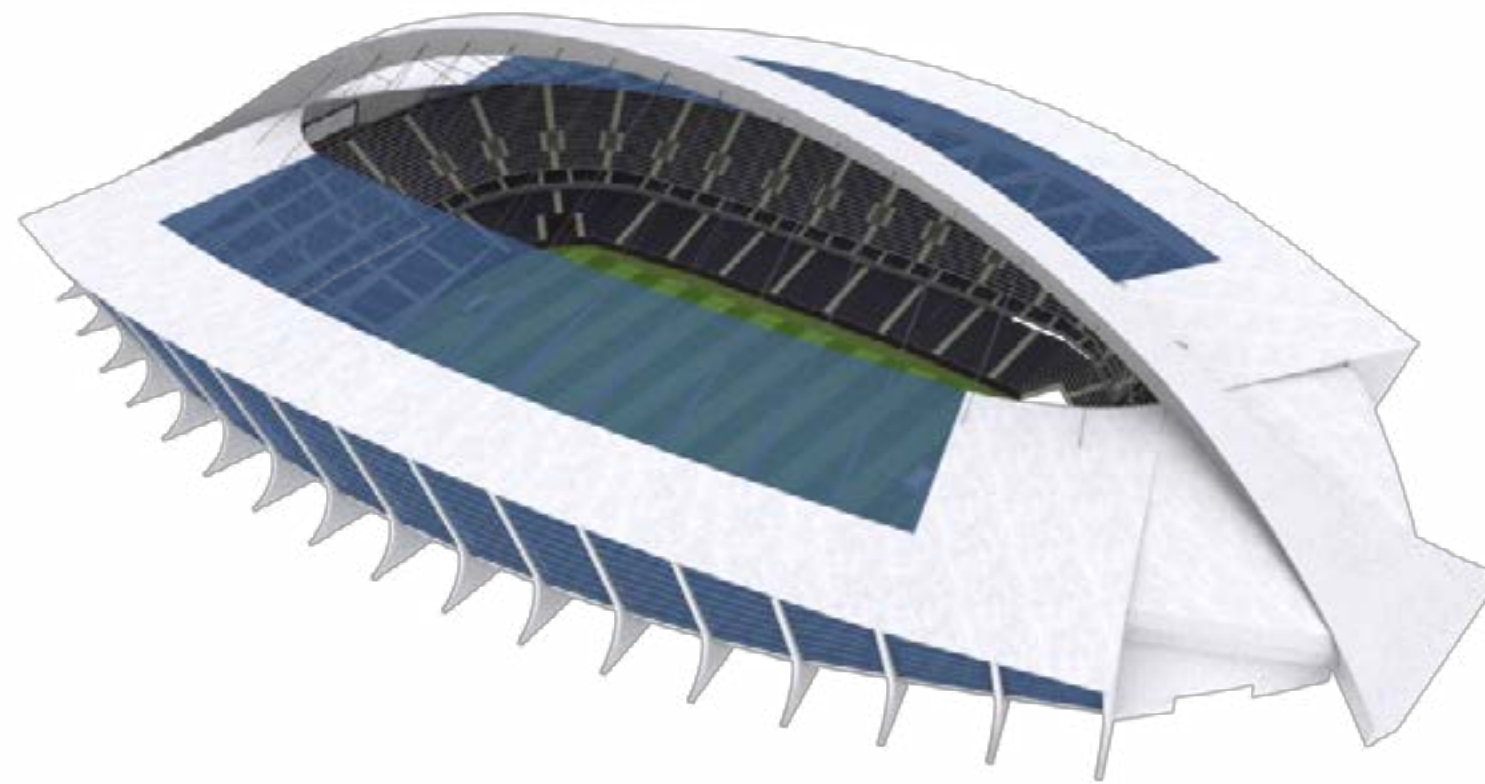

Luso-Brasileiro Stadium is used for regular team Football by a top second division team in the Brazilian league. It is a modern stadium built on an island close to Rio de Janeiro.



[PLAY STADIUM FLYBY](#)

FOOTBALL STADIUMS - BRAZIL

MANUAS

CAPACITY : 44,000

CONSTRUCTED : 2013

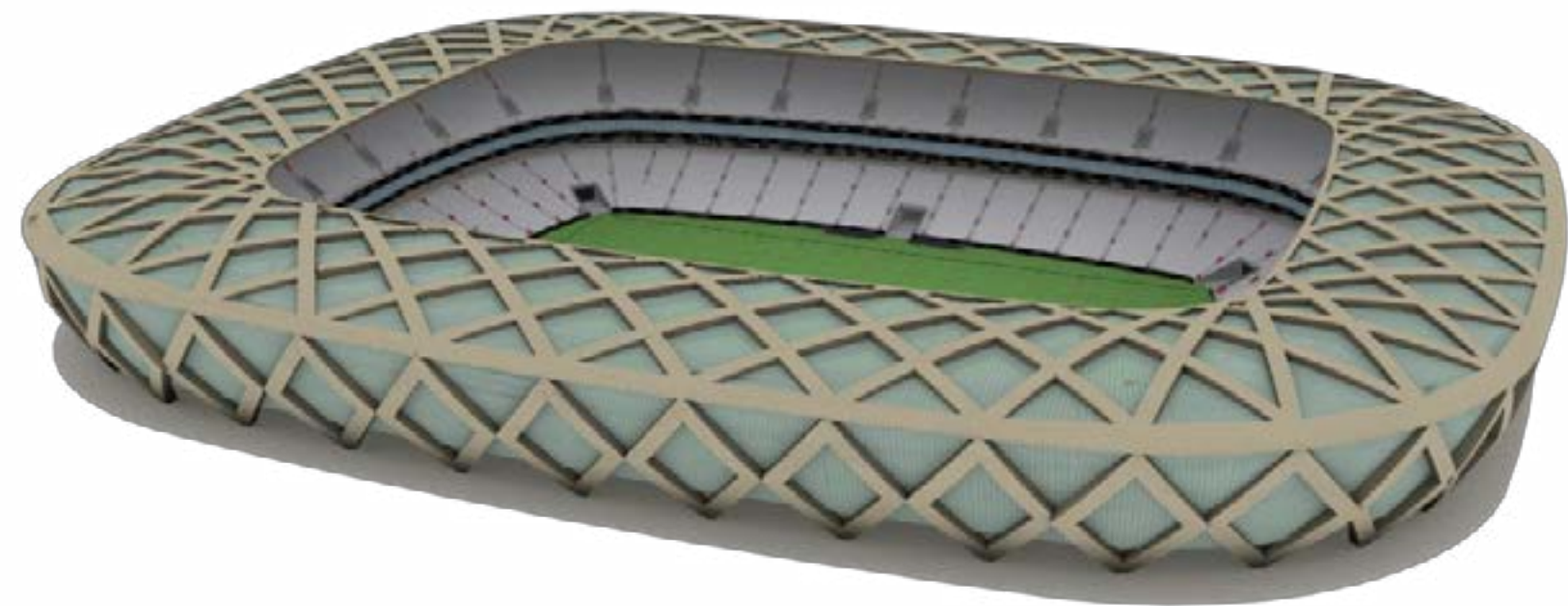

Manuas is used for regular team football in the Brazilian League by three football teams. Amazonas Arena was chosen for the 2014 World Cup hosting 4 matches and the 2016 Summer Olympics football matches.



[PLAY STADIUM FLYBY](#)

FOOTBALL STADIUMS - BRAZIL

RECIFE

CAPACITY : 46,000

CONSTRUCTED : 2013

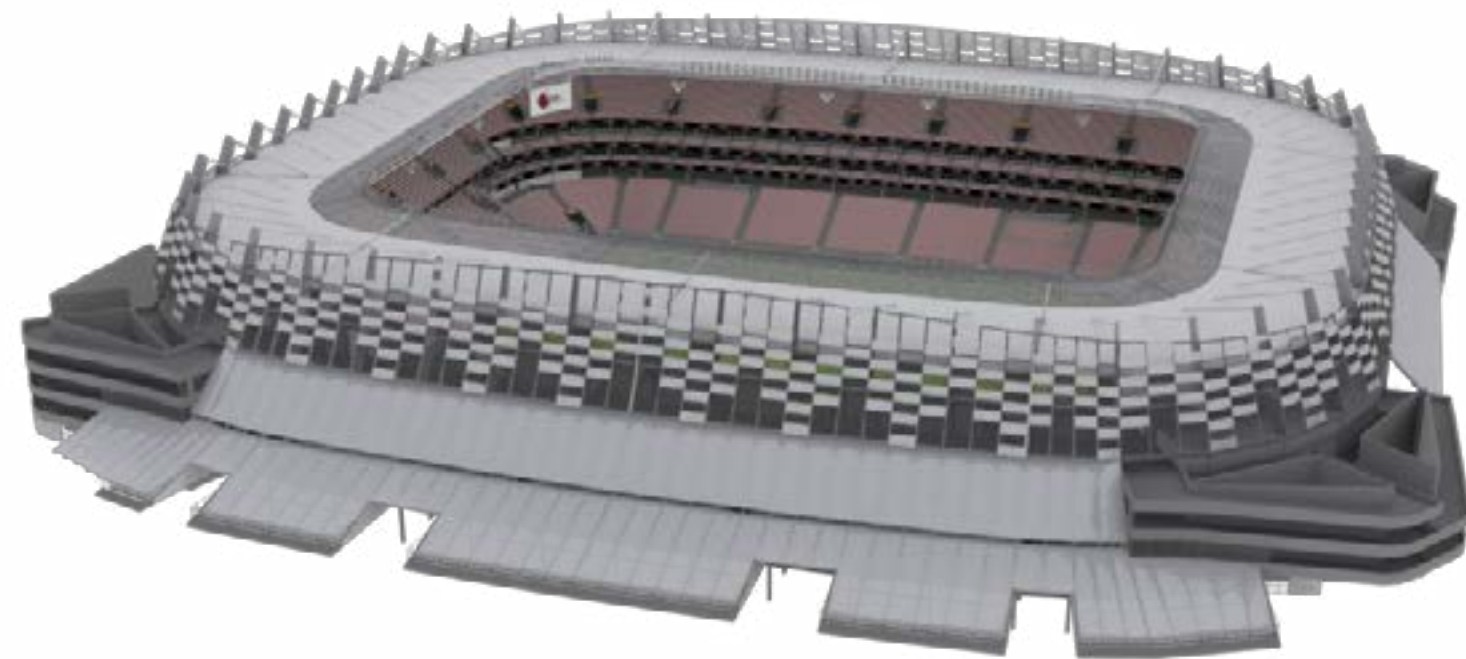

Recife is a new stadium used for regular team football in the Brazilian league, in Pernambuco. The Itaipava Pernambuco Arena was built for the 2014 World Cup, hosting 5 matches and the 2013 Confederations Cup.



[PLAY STADIUM FLYBY](#)

FOOTBALL STADIUMS - BRAZIL

RIO DE JANEIRO

CAPACITY : 78,838

CONSTRUCTED : 1950



Rio de Janeiro is used for regular team football by the current champions of the Brazilian league. The Maracana Stadium hosted the 1950 World Cup and the 2014 World Cup with 7 matches including the Final.



[PLAY STADIUM FLYBY](#)

FOOTBALL STADIUMS - BRAZIL

SALVADOR

CAPACITY : 55,000

CONSTRUCTED : 2013

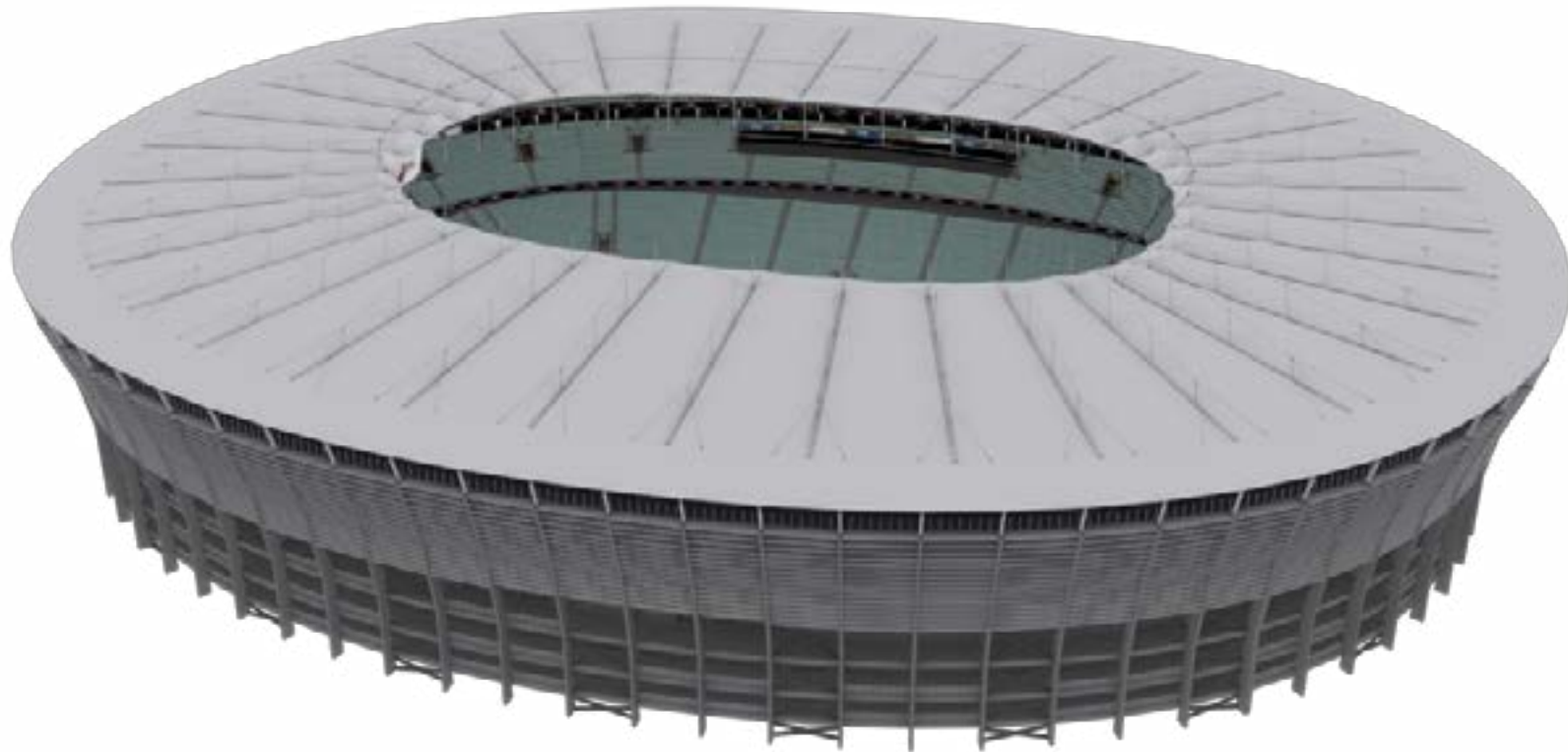

Salvador is used for regular football for two teams in the Brazilian league, in Salvador. The Fonte Nova Arena hosted the 2013 Confederations Cup, the 2014 World Cup and the 2016 Summer Olympic football matches.



[PLAY STADIUM FLYBY](#)

FOOTBALL STADIUMS - BRAZIL

SAO PAULO

CAPACITY : 48,234

CONSTRUCTED : 2013

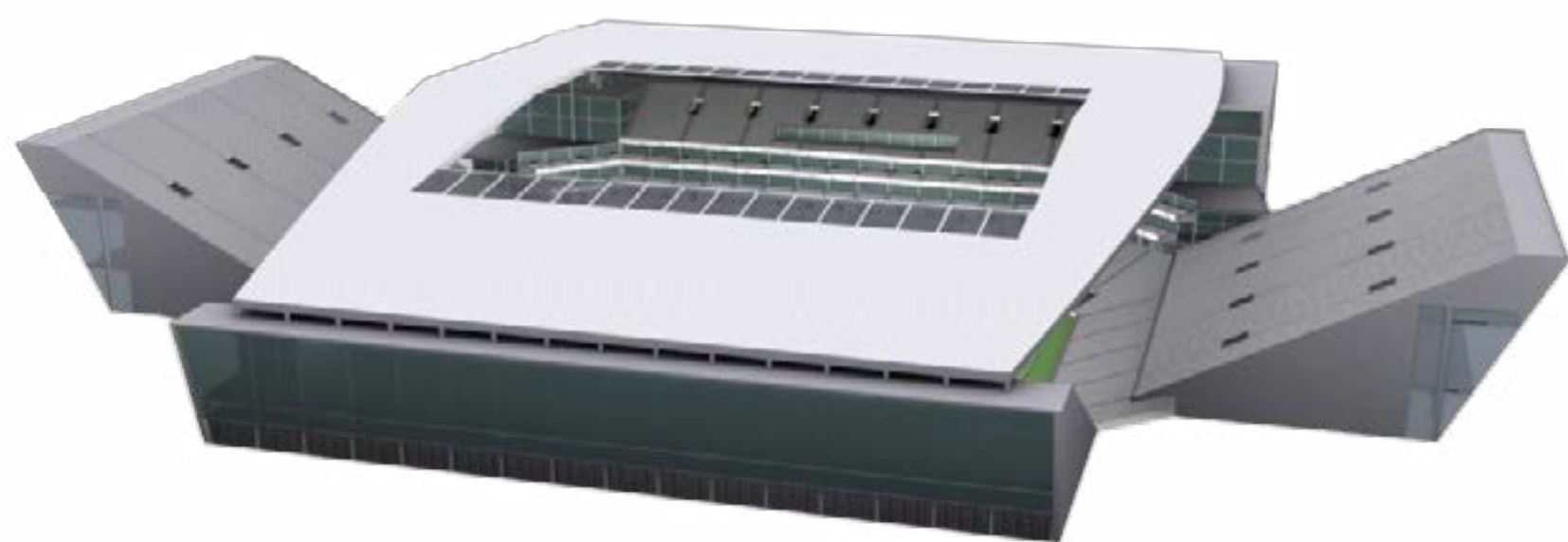

Sao Paulo is used for regular team football in the Brazilian league. The New Corinthians Stadium was especially re-built for the 2014 World Cup, hosting 6 matches including the opening game and a semi-final match.



[PLAY STADIUM FLYBY](#)